

About **WEISS/MANFREDI**
Architecture/Landscape/Urbanism

WEISS/MANFREDI Architecture/Landscape/Urbanism is a multidisciplinary design practice based in New York City. Founded by Marion Weiss and Michael Manfredi, the award-winning firm is known for its integration of architecture, art, infrastructure, and landscape design. Their recently completed Olympic Sculpture Park for the Seattle Art Museum was the winner of an international design competition and was recently recognized as the Nature Category winner at the World Architecture Festival. The project was judged Best in the Environments Category of the 2008 I.D. Magazine Design Review, and was the first North American project to be awarded the Veronica Rudge Green prize in Urban Design by Harvard University Graduate School of Design.

IMAGINE being part of the KMA transformation.
For **MORE** information contact us at
imaginemore@katonahmuseum.org
or **914-232-9555 ext. 2997**

Renderings by WEISS/MANFREDI Architecture/Landscape/Urbanism
Design by Naomi Leiseroff

 **Katonah Museum of Art**
134 Jay Street
Katonah, NY 10536
(914) 232-9555
www.katonahmuseum.org



Past



Existing Elevation

Present



Future



Proposed Elevation

Katonah Museum of Art

imagine

MORE

THE KMA TRANSFORMED

The Katonah Museum of Art is bursting at the seams with its ambitious programs, exhibitions, educational collaborations, and public events. The 20-year-old building is in need of repair and its climate control system requires an upgrade. And so the KMA is **imagining MORE**.

- imagine MORE** outdoor galleries for monumental public art.
- imagine MORE** space for jazz concerts, family programs, lectures, and poetry readings.
- imagine MORE** paths where families can look at art while enjoying nature.
- imagine MORE** ways to reduce our carbon footprint through geothermal technology and energy-efficient design.
- imagine MORE** ways to make the KMA's grounds and galleries physically accessible to all visitors.

The award-winning architectural firm of Weiss/Manfredi has designed new outdoor sculpture galleries that will be open to the public and visible to all who drive or walk by the KMA, creating an inviting cultural landscape for visitors of all ages. The grounds will be enhanced by planting indigenous trees, shrubs, and meadow grasses. Artists will collaborate in all aspects of the design. **Imagine** art and nature intertwined in newly accessible, exciting, and thought-provoking ways.

Neil Watson
Executive Director

Proposed View from Route 22



imagine **MORE** ways that you can enjoy the KMA

Proposed Sculpture Garden View



imagine a glass pavilion for readings, music, and **MORE**

Proposed Site Plan

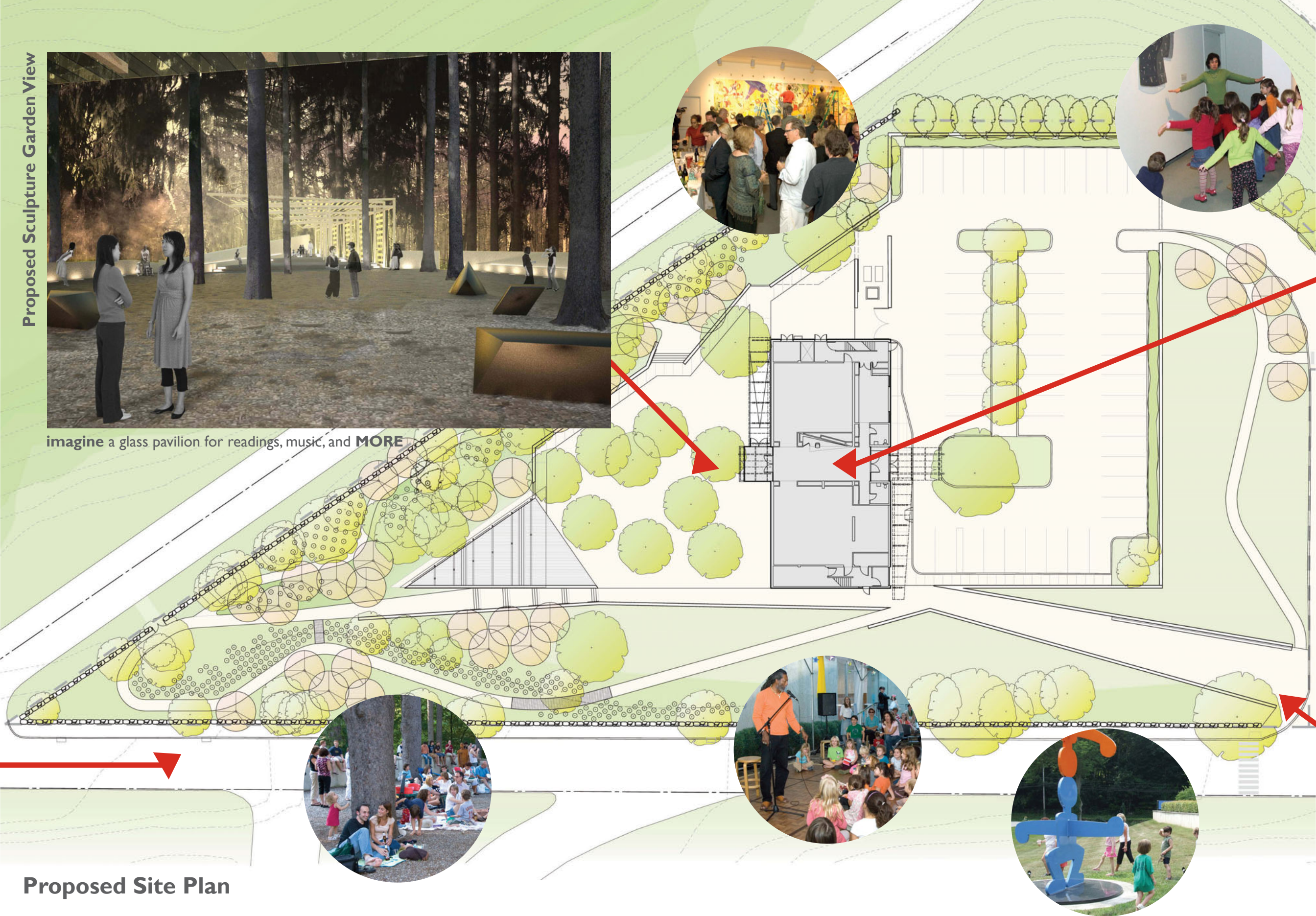

Proposed Interior View



imagine a dazzling atrium with **MORE** room for socializing and shopping

Proposed View from Route 22



imagine a broad welcoming walkway with views of sculpture throughout the landscape